

LEDJ

Stage Par CZ200 Dual White

User Manual



Order code: LEDJ194

WARNING

FOR YOUR OWN SAFETY, PLEASE READ THIS USER MANUAL CAREFULLY BEFORE YOUR INITIAL START-UP!

- Before your initial start-up, please make sure that there is no damage caused during transportation.
- Should there be any damage, consult your dealer and do not use the equipment.
- To maintain the equipment in good working condition and to ensure safe operation, it is necessary for the user to follow the safety instructions and warning notes written in this manual.
- Please note that damages caused by user modifications to this equipment are not subject to warranty.



IMPORTANT:

The manufacturer will not accept liability for any resulting damages caused by the non-observance of this manual or any unauthorised modification to the equipment.

- Never let the power cable come into contact with other cables. Handle the power cable and all mains voltage connections with particular caution!
- Never remove warning or informative labels from the unit.
- Do not open the equipment and do not modify the unit.
- Do not connect this equipment to a dimmer pack.
- Do not switch the equipment on and off in short intervals, as this will reduce the system's life.
- Only use the equipment indoors.
- Do not expose to flammable sources, liquids or gases.
- Always disconnect the power from the mains when equipment is not in use or before cleaning! Only handle the power-cable by the plug. Never pull out the plug by pulling the power-cable.
- Make sure that the available mains supply voltage is between 100~240V AC, 50/60Hz.
- Make sure that the power cable is never crimped or damaged. Check the equipment and the power cable periodically.
- If the equipment is dropped or damaged, disconnect the mains power supply immediately and have a qualified engineer inspect the equipment before operating again.
- If the equipment has been exposed to drastic temperature fluctuation (e.g. after transportation), do not connect power or switch it on immediately. The arising condensation might damage the equipment. Leave the equipment switched off until it has reached room temperature.
- If your product fails to function correctly, stop use immediately. Pack the unit securely (preferably in the original packing material), and return it to your Pro Light dealer for service.
- Only use fuses of same type and rating.
- Repairs, servicing and power connection must only be carried out by a qualified technician. THIS UNIT CONTAINS NO USER SERVICEABLE PARTS.
- This lighting fixture is for professional use only - it is not designed for or suitable for household use. The product must be installed by a qualified technician in accordance with local territory regulations. The safety of the installation is the responsibility of the installer. The fixture presents risks of severe injury or death due to fire hazards, electric shock and falls.
- Warning! Risk Group 2 LED product according to EN 62471. Do not view the light output with optical instruments or any device that may concentrate the beam.
- WARRANTY: One year from date of purchase.

OPERATING DETERMINATIONS

If this equipment is operated in any other way, than those described in this manual, the product may suffer damage and the warranty becomes void. Incorrect operation may lead to danger e.g: short-circuit, burns and electric shocks etc.

Do not endanger your own safety and the safety of others!

Incorrect installation or use can cause serious damage to people and/or property.

Stage Par CZ200 Dual White

The CZ200 Dual White Stage Par is powered by a high output 200W cool white/warm white COB (chip-on-board) LED, ideal for stage productions, concerts or theatre applications. The motorised zoom allows the beam angle to be adjusted via DMX or manual modes between 13° and 50° and on-board controls offer 4 different dimmer curve options, whilst the 5-pin DMX and powerCON input/output allow for easy connections, adding to the host of professional features on these fixtures. A gel frame holder is supplied enabling diffusion filters to be fitted.



- 1 x 200W cool white (6250K) and warm white (3000K) COB LED (CW/WW)
- Adjustable beam angle: 13° - 50°
- 13° - 26,856 Lux @ 2m (full on), 50° - 3,020 Lux @ 2m (full on)
- CRI: 92
- 11.8kHz refresh rate
- Motorised zoom
- DMX channels: 2/3/4/5 or 7 selectable
- Manual mode
- 0 - 100% dimming with variable strobe
- Supplied with hanging bracket
- 4 push button menu with LED display
- PowerCON input/output
- 5-Pin XLR input/output
- Fan cooled
- Supplied with filter frame

13° - Lux					
FULL ON	107424	26856	11936	6714	4297
CW	62992	15748	6999	3937	2520
WW	46560	11640	5173	2910	1862

50° - Lux					
FULL ON	12080	3020	1342	755	483
CW	7232	1808	804	452	289
WW	5520	1380	613	345	221

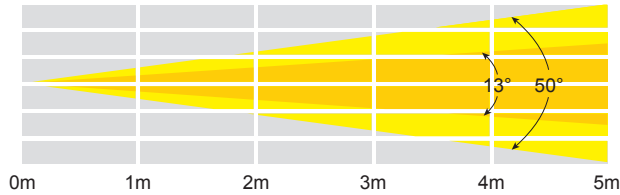

Specifications	Stage Par CZ200 Dual White
Power consumption	217W
Power supply	100~240V, 50/60Hz
Fuse	F4A 250V
Dimensions	370 x 275 x 390mm
Weight	4.3kg
Order codes	LEDJ194

- 01 - LED display
- 02 - Function buttons
- 03 - 5-Pin XLR input
- 04 - 5-Pin XLR output
- 05 - PowerCON input
- 06 - PowerCON output
- 07 - Fuse F4A 250V
- 08 - Earth point
- 09 - Safety eye
- 10 - Hanging bracket
- 11 - Hanging bracket adjustment knob

In the box: **1 x fixture, 1 x filter frame & 1 x power cable**

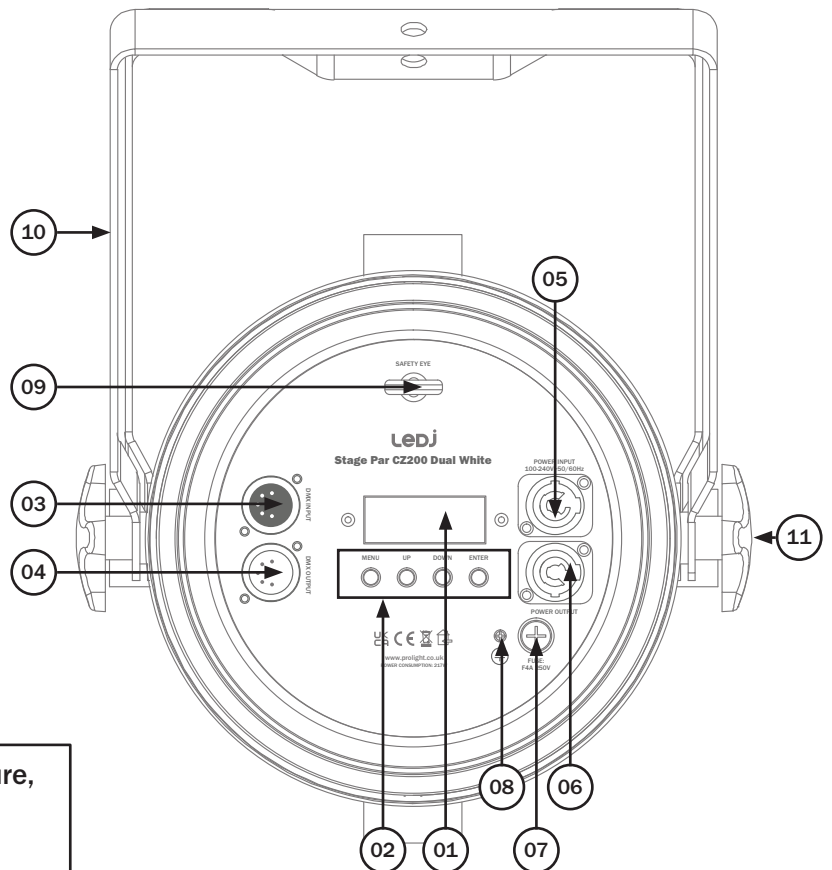

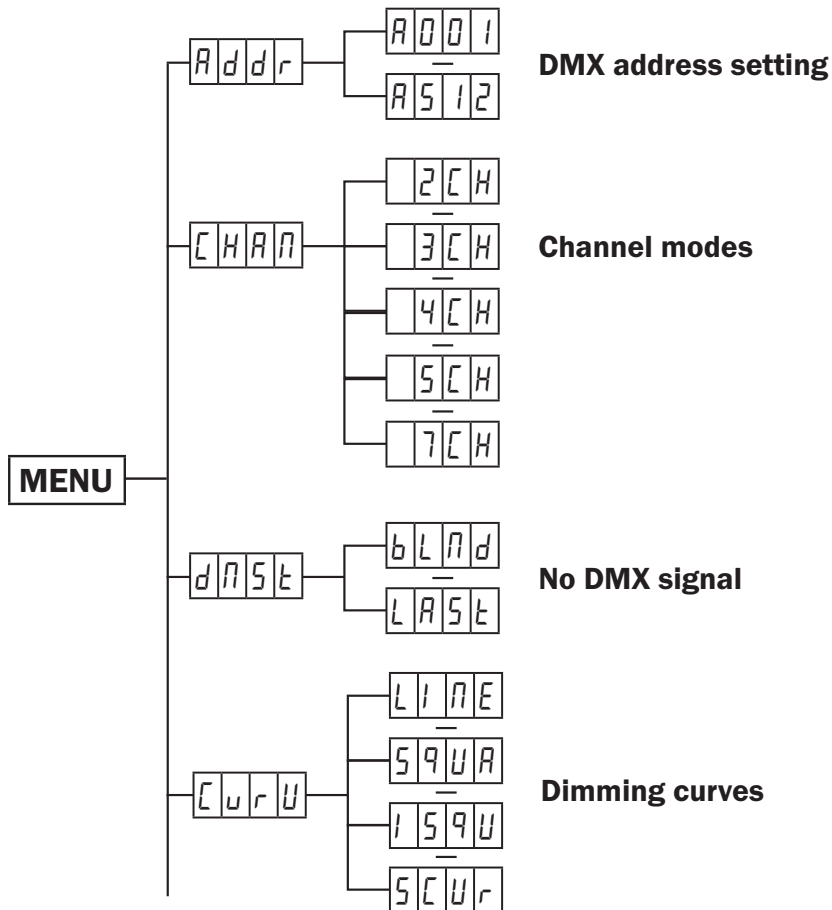
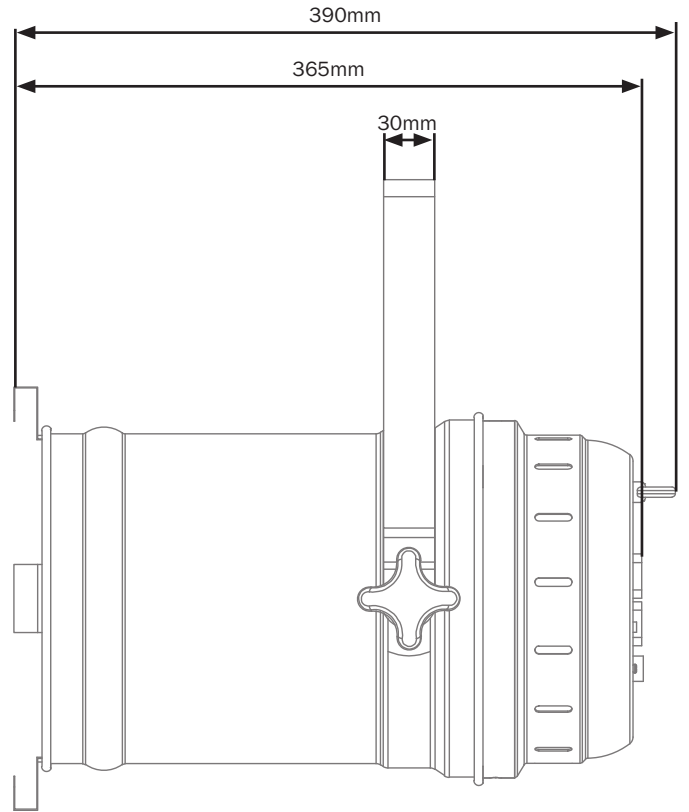
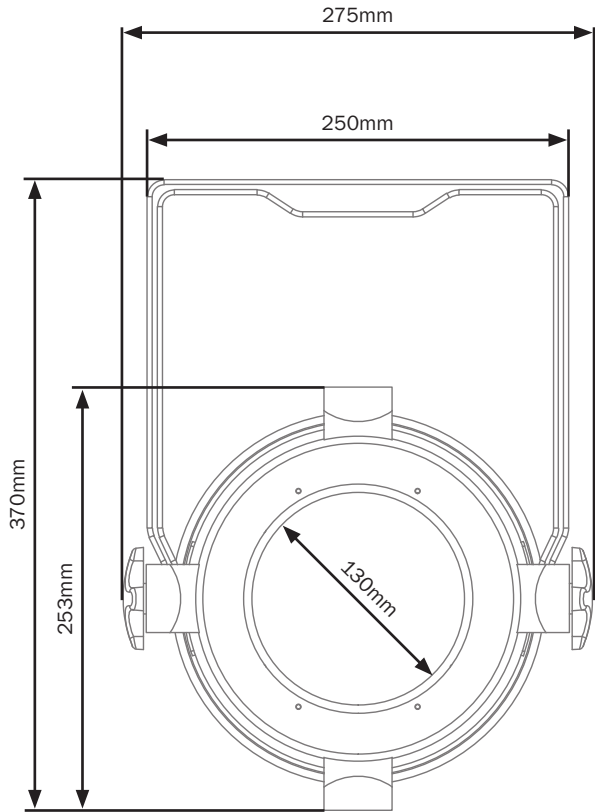

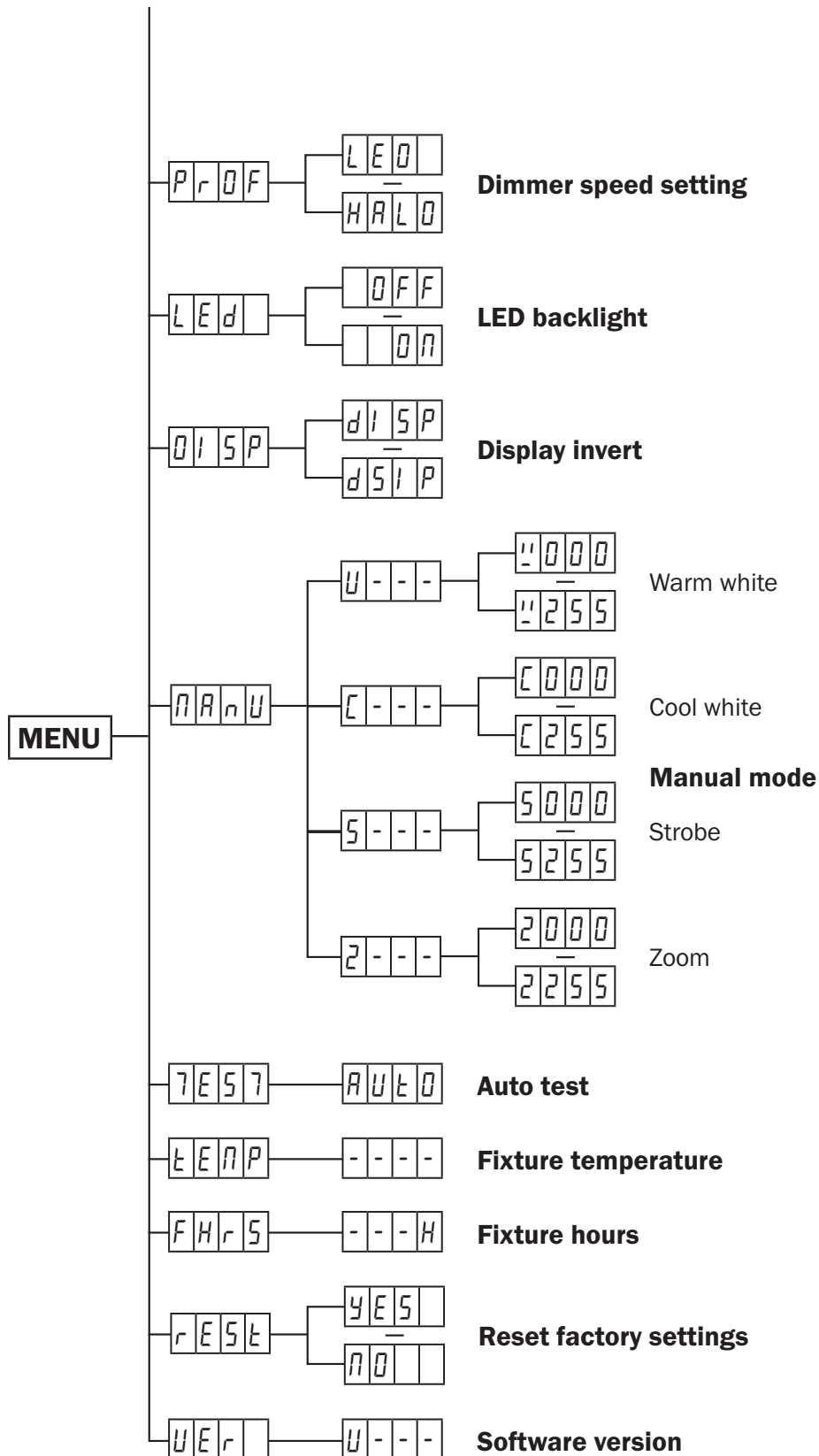

DMX mode:

Operating in a DMX control mode environment gives the user the greatest flexibility when it comes to customising or creating a show. In this mode you will be able to control each individual trait of the fixture and each fixture independently.

To access the DMX address mode, press the “MENU” button and use the “UP” and “DOWN” buttons to show *ADDR* on the LED display. Now press the “ENTER” button and use the “UP” and “DOWN” buttons to set the required DMX address. Press the “ENTER” button to confirm the setting.

To exit out of any of the above options, press the “MENU” button.

DMX channel mode:

To access the DMX channel mode, press the “MENU” button and use the “UP” and “DOWN” buttons to show *CHAN* on the LED display. Now press the “ENTER” button and use the “UP” and “DOWN” buttons to choose one of the 2/3/4/5 or 7 DMX channel modes. Press the “ENTER” button to confirm the setting. To exit out of any of the above options, press the “MENU” button.

2 channel mode:

Channel	Value	Function
CH1	000-255	Master dimmer (0-100%) - both colours
CH2	000-255	Zoom (marrow-wide)

3 channel mode:

Channel	Value	Function
CH1	000-255	Warm White dimmer (0-100%)
CH2	000-255	Cool White dimmer (0-100%)
CH3	000-255	Zoom (marrow-wide)

4 channel mode:

Channel	Value	Function
CH1	000-255	Master dimmer (0-100%)
CH2	000-255	Warm White dimmer (0-100%)
CH3	000-255	Cool White dimmer (0-100%)
CH4	000-255	Zoom (marrow-wide)

7 channel mode:

Channel	Value	Function
CH1	000-255	Master dimmer (0-100%)
CH2	000-255	Warm White dimmer (0-100%)
CH3	000-255	Cool White dimmer (0-100%)
CH4	000-255	Zoom (narrow-wide)
CH5	000-255	Zoom speed (fast-slow)
CH6	000-031	No function
	032-063	Open
	064-095	Strobe (slow-fast)
	096-127	Open
	128-159	Pulse strobe (slow-fast)
	160-191	Open
	192-223	Random strobe (slow-fast)
CH7	224-255	Open
	000-050	Default (set on unit)
	051-100	Linear
	101-150	Square
	151-200	Inverse Square
	201-240	S-Curve
	241-250	No function
	251-255	Reset (hold 5s)

5 channel mode:

Channel	Value	Function
CH1	000-255	Master dimmer (0-100%)
CH2	000-255	Warm White dimmer (0-100%)
CH3	000-255	Cool White dimmer (0-100%)
CH4	000-255	Zoom (narrow-wide)
CH5	000-031	No function
	032-063	Open
	064-095	Strobe (slow-fast)
	096-127	Open
	128-159	Pulse strobe (slow-fast)
	160-191	Open
	192-223	Random strobe (slow-fast)
	224-255	Open

No DMX signal:

To change how the unit responds when the DMX signal is lost, press the “MENU” button and use the “UP” and “DOWN” buttons to show *DNSE* on the LED display. Now press the “ENTER” button and use the “UP” and “DOWN” buttons to choose between *LASE* (Hold the last DMX command) or *BLND* (Blackout). Press the “ENTER” button to confirm the setting.

To exit out of any of the above options, press the “MENU” button.

Dimming curves:

To access the dimming curve setting, press the “MENU” button to show *CURV* on the LED display. Now press the “ENTER” button and use the “UP” and “DOWN” buttons to choose between *LINE* (Linear), *SQUR* (Square), *ISQU* (Inverse square) or *SCUR* (S-Curve).

Press the “ENTER” button to confirm the setting.

To exit out of any of the above options, press the “MENU” button.

Dimming speed:

To access the dimmer speed setting, press the “MENU” button and use the “UP” and “DOWN” buttons to show *PRDF* on the LED display. Now press the “ENTER” button and use the “UP” and “DOWN” buttons to choose between *LED* (LED) or *HALD* (Halogen).

Press the “ENTER” button to confirm the setting.

To exit out of any of the above options, press the “MENU” button.

LED backlight:

To access the LED backlight setting, press the “MENU” button and use the “UP” and “DOWN” buttons to show *LEDB* on the LED display. Now press the “ENTER” button and use the “UP” and “DOWN” buttons to choose between *ON* or *OFF*. Press the “ENTER” button to confirm the setting. To exit out of any of the above options, press the “MENU” button.

Display invert setting:

To access the display invert setting, press the “MENU” button and use the “UP” and “DOWN” buttons to show *DISP* on the LED display. Now press the “ENTER” button and use the “UP” and “DOWN” buttons to choose between *DISP* or *dSP*. Press the “ENTER” button to confirm the setting. To exit out of any of the above options, press the “MENU” button.

Manual mode:

To access manual mode, press the “MENU” button to show *MANU* on the LED display.

Now press the “ENTER” button and use the “UP” and “DOWN” buttons to choose between *W* (Warm White dimmer), *C* (Cool White dimmer), *S* (Strobe) and *Z* (Zoom).

Press the “ENTER” button and use the “UP” and “DOWN” buttons to choose between *000 ~ 255*.

Press the “ENTER” button to confirm the setting.

To exit out of any of the above options, press the “MENU” button.

Test mode:

To access the test mode, press the “MENU” button and use the “UP” and “DOWN” buttons to show *TES 7* on the LED display. Now press the “ENTER” button.

The unit will now display *AUTO* and run the fixtures test mode.

To exit out of any of the above options, press the “MENU” button.

Fixture temperature:

To access the fixtures temperature, press the “MENU” button and use the “UP” and “DOWN” buttons to show *TEMP* on the LED display. Now press the “ENTER” button.

The unit will now display the fixtures temperature.

To exit out of any of the above options, press the “MENU” button.

Fixture hours:

To access the fixtures usage time, press the “MENU” button and use the “UP” and “DOWN” buttons to show *FHRS* on the LED display. Now press the “ENTER” button.

The unit will now display the fixtures usage time (hours).

To exit out of any of the above options, press the “MENU” button.

Reset factory settings:

To reset factory settings, press the “MENU” button and use the “UP” and “DOWN” buttons to show *RES 7* on the LED display. Now press the “ENTER” button and use the “UP” and “DOWN” buttons to choose *YES*. Press the “ENTER” button to confirm the setting. The fixture will reset to factory default settings. To exit out of any of the above options, press the “MENU” button.

Software version:

To access the fixtures software version, press the “MENU” button and use the “UP” and “DOWN” buttons to show *VER* on the LED display. Now press the “ENTER” button.

The unit will now display the fixtures software version.

To exit out of any of the above options, press the “MENU” button.

Setting the DMX address:

The DMX mode enables the use of a universal DMX controller. Each fixture requires a “start address” from 1- 512. A fixture requiring one or more channels for control begins to read the data on the channel indicated by the start address. For example, a fixture that occupies or uses 7 channels of DMX and was addressed to start on DMX channel 100, would read data from channels: 100, 101, 102, 103, 104, 105 and 106. Choose a start address so that the channels used do not overlap. E.g. the next unit in the chain starts at 107.

DMX 512:

DMX (Digital Multiplex) is a universal protocol used as a form of communication between intelligent fixtures and controllers. A DMX controller sends DMX data instructions from the controller to the fixture. DMX data is sent as serial data that travels from fixture to fixture via the DATA “IN” and DATA “OUT” XLR terminals located on all DMX fixtures (most controllers only have a data “out” terminal).

DMX linking:

DMX is a language allowing all makes and models of different manufactures to be linked together and operate from a single controller, as long as all fixtures and the controller are DMX compliant. To ensure proper DMX data transmission, when using several DMX fixtures try to use the shortest cable path possible. The order in which fixtures are connected in a DMX line does not influence the DMX addressing. For example; a fixture assigned to a DMX address of 1 may be placed anywhere in a DMX line, at the beginning, at the end, or anywhere in the middle. When a fixture is assigned a DMX address of 1, the DMX controller knows to send DATA assigned to address 1 to that unit, no matter where it is located in the DMX chain.

DATA cable (DMX cable) requirements (for DMX operation):

This fixture can be controlled via DMX-512 protocol. The DMX address is set on the back of the unit. Your unit requires either a standard 3-pin or 5-pin XLR connector for data input/output, see images below.

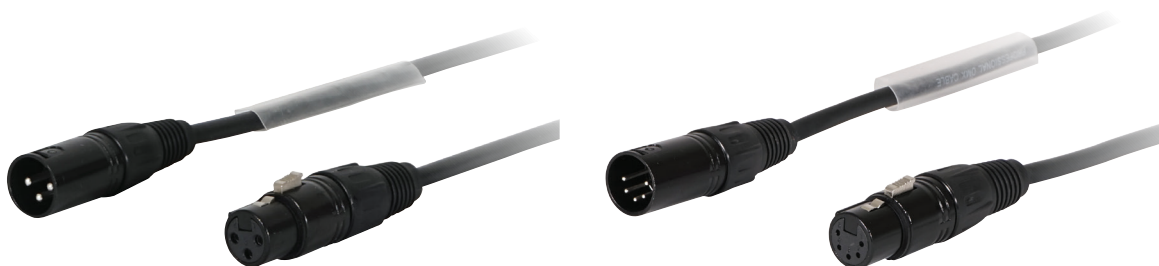

Further DMX cables can be purchased from all good sound and lighting suppliers or Prolight Concepts dealers.

Please quote:	3-Pin:	CABL10 - 2m	CABL11 - 5m	CABL12 - 10m
	5-Pin:	CABL185 - 2m	CABL187 - 5m	CABL188 - 10m

Also remember that DMX cable must be daisy chained and cannot be split.

Notice:

Be sure to follow the diagrams below when making your own cables. Do not connect the cables shield conductor to the ground lug or allow the shield conductor to come in contact with the XLRs outer casing. Grounding the shield could cause a short circuit and erratic behaviour.

Pin Configuration	
3-Pin	5-Pin
	Pin 1 - Ground
	Pin 2 - Negative
	Pin 3 - Positive
-	Pin 4 - N/C
-	Pin 5 - N/C

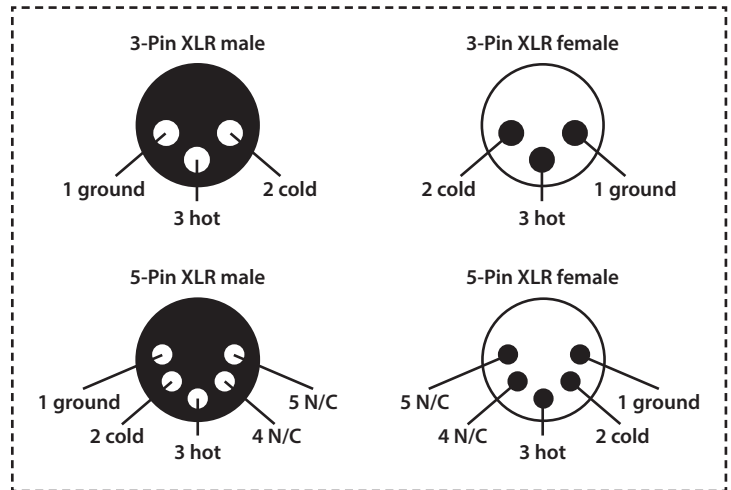
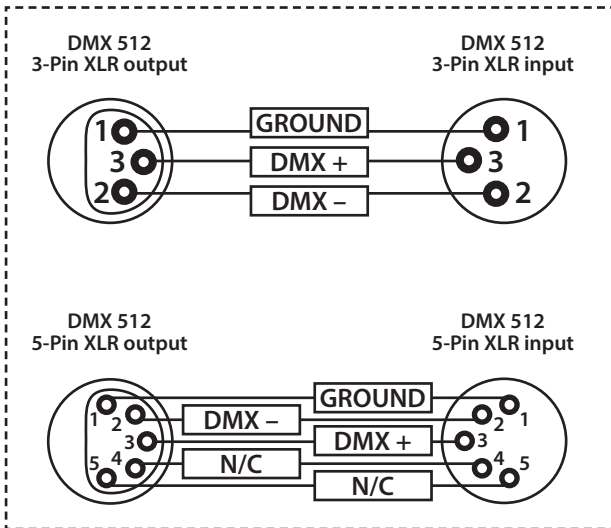

Line termination:

When longer runs of cable are used, you may need to use a terminator on the last unit to avoid erratic behaviour.

Using a cable terminator will decrease the possibilities of erratic behaviour.

(3-pin - Order ref: CABL90,
5-pin - Order ref: CABL89)

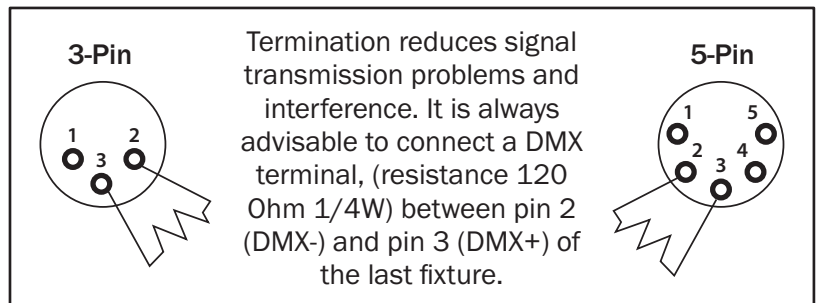

5-pin XLR DMX connectors:

Some manufactures use 5-pin XLR connectors for data transmission in place of 3-pin. 5-pin XLR fixtures may be implemented in a 3-pin XLR DMX line. When inserting standard 5-pin XLR connectors in to a 3-pin line a cable adaptor must be used. The diagram below details the correct cable conversion.

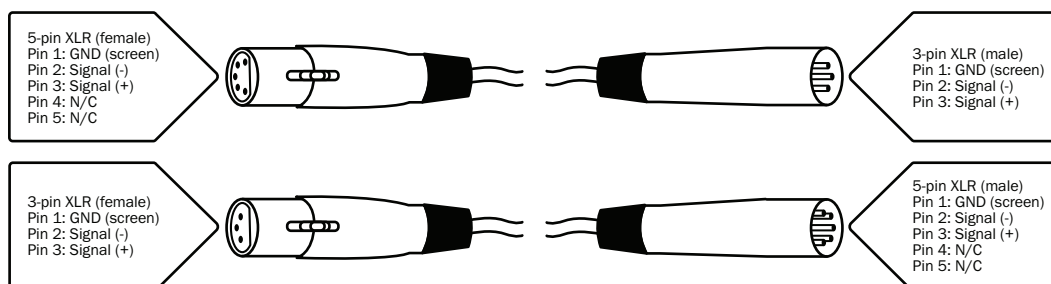

Power linking:

This fixture provides power linking via the power output on the rear allowing multiple units to be connected together. The maximum number of fixtures that can be connected is 8 fixtures @ 240V or 4 fixtures @ 120V (including the first fixture). After the maximum number of fixtures are connected a new power run will need to be started.

Please note: Caution should be used when power linking other fixtures to the Stage Par CZ200 Dual White as the power consumption of other fixtures will vary. Fixtures fitted with lamps often require 2/3 times more current on startup, these may require their own power source.

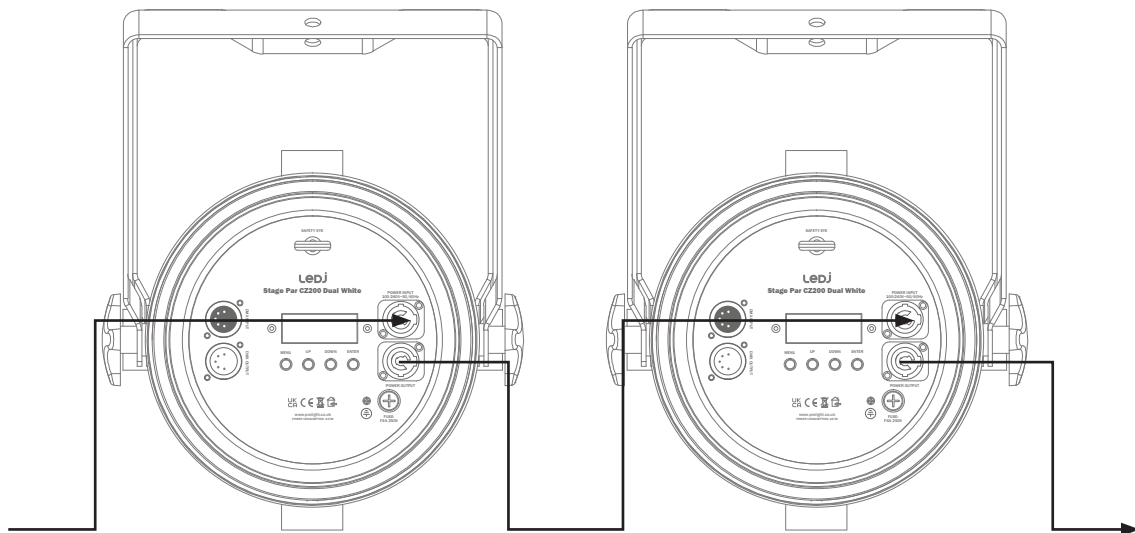



***Correct Disposal of this Product
(Waste Electrical & Electronic Equipment)***

(Applicable in the European Union and other European countries
with separate collection systems)

This marking shown on the product or its literature, indicates that it should not be disposed of with other household wastes at the end of its working life. To prevent possible harm to the environment or human health from uncontrolled waste disposal, please separate this from other types of wastes and recycle it responsibly to promote the sustainable reuse of material resources.

Household users should contact either the retailer where they purchased this product, or their local government office, for details of where and how they can take this item for environmentally safe recycling.

Business users should contact their supplier and check the terms and conditions of the purchase contract. This product should not be mixed with other commercial wastes for disposal.

