



APPLICATIONS

- Band P.A.
- Personal monitor
- Small theatres
- Auditoriums
- Piano bar
- DJ
- Stage monitor
- Conference rooms
- Fixed installations in live clubs
- Pubs
- Gyms

KEY FEATURES

- 2-way passive system
- Polypropylene molded enclosure
- FBT custom 12" LF woofer / 2" voice coil
- FBT 1" throat / 1,4" voice coil HF compression driver
- 300W RMS recommended amplifier
- 30° or 45° monitor taper
- M10 rigging points
- 90°H x 60°V constant directivity horn



SOUND REINFORCEMENT SPEAKER



PRODUCT DESCRIPTION

The FBT X-LITE 12 series speakers feature lightweight, yet rugged gas injected molded polypropylene cabinet construction. Available in black finish the FBT X-LITE 12 series speakers modern cabinet appearance provides fixed installations with an elegant design that blends into any decor. The asymmetrical shape of the FBT X-LITE 12 cabinet also allows use as a floor stage monitor. The FBT X-LITE 12 is two way design incorporating an 12" low frequency woofer and 1" HF compression driver coupled to a 90°H x 60°V constant directivity horn. With a frequency range of 56Hz - 20kHz the FBT X-LITE 12 speakers provide high fidelity sound for both speech and music applications with a maximum SPL of 125dB. Ideal for small fixed installations the FBT X-LITE 12 speaker have an impedance of 8 Ohm and the internal crossover is at a fixed frequency of 2kHz. The control panel features 2 x NL4 Neutrik speakon. 4 x M10 rigging points built into the cabinet along with the optional mounting brackets allow the FBT X-LITE 12 speaker to be surface mounted on walls or ceilings. A standard 1,38" speaker stand socket allows the FBT X-LITE 12 to be mounted on speaker stand. A front face steel grille protects the speaker from external damage.

ELECTRONIC SPECIFICATIONS

System Type	2 Way
Recommended amplifier	300W RMS
Long term power*	150W
Short term power**	600W
Nominal Impedance	8 Ohm
Frequency Response	56Hz - 20kHz (@-6dB)
Maximum SPL cont/peak	122/125dB
Dispersion	90° H x 60°V
Crossover frequency	2kHz
Recommended ext. DSP	FBT DLM26

PHYSICAL SPECIFICATIONS

Low Frequency Woofer	12" / 2" coil
High Frequency Driver	1" / 1,4" coil
Input Connectors	2 x speakon
Net Dimensions (WxHxD) inch	14,01 x 24,37 x 14,05
mm	356 x 619 x 357
Shipping Dimensions (WxHxD) inch	17,32 x 27,75 x 17,32
mm	440 x 705 x 440
Net Weight	36,15 lbs
Enclosure Material	polypropylene
Grille	Steel with powder coat black paint finish

* 100 hour power test, IEC 268-5 standard (display the long term RMS voltage handling, using IEC filtered 6dB crest factor pink noise)

** Based on peak level of 6dB crest factor random noise signal used for test.

DIMENSIONAL DRAWINGS

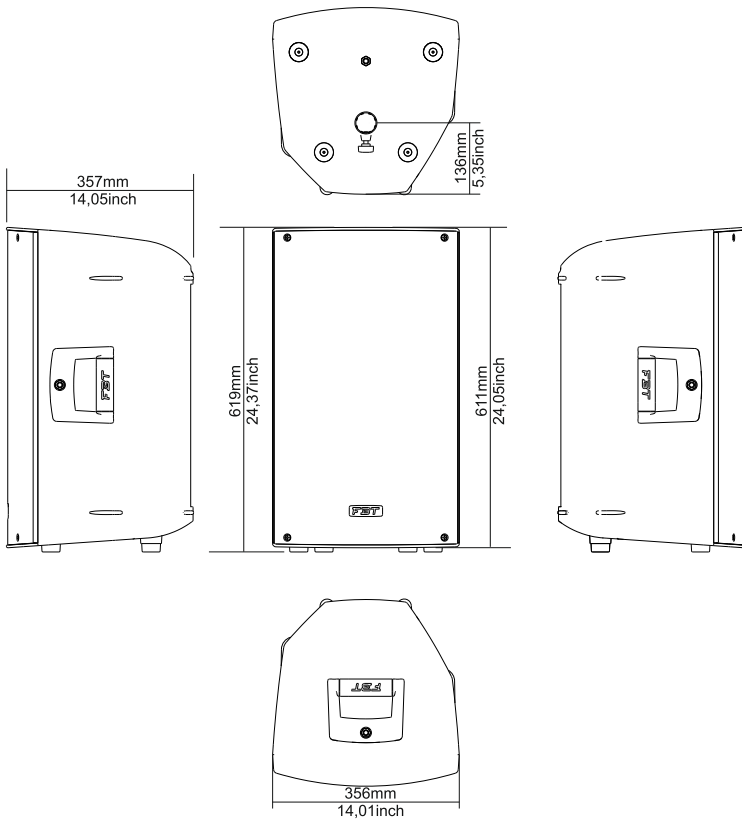

CONTROL PANEL



ACCESSORIES

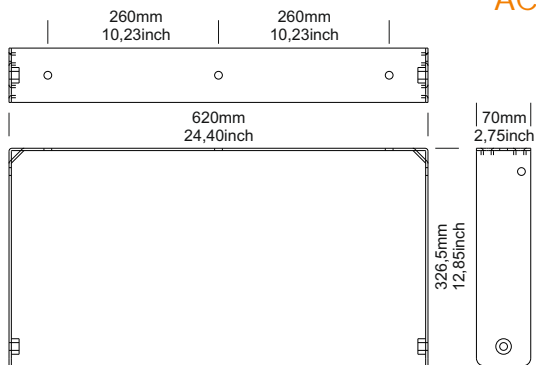

XL-UH12
Wall metal bracket to mount in horizontal position

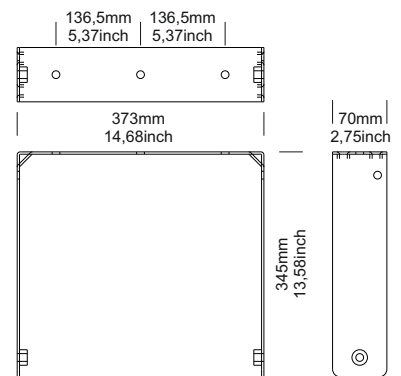

XL-UV12
Wall metal bracket to mount in vertical position